

# Fitting Guide

## Nathos Nova M Slimtube

### Nathos™ Nova M Slimtube

- 1 Right or left indicator\* on back of hearing aid
- 2 Battery compartment with ON/OFF switch
- 3 Multi-function button
- 4 Slim tube
- 5 Retention cord
- 6 Speaker (with Dome earpiece attached)

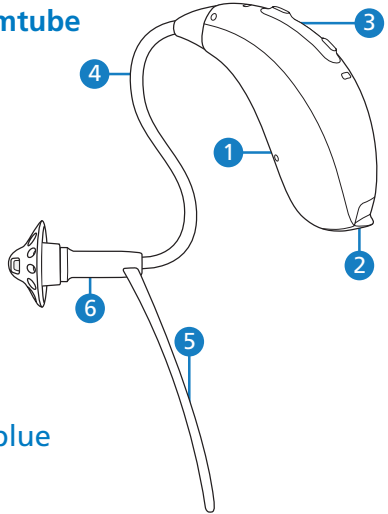

\***Right = red** | **Left = blue**

### Turning on the hearing system

Switch on/off the hearing system by opening/closing the battery compartment (below).

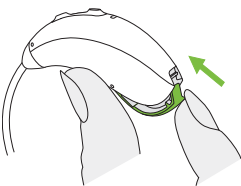

**on**

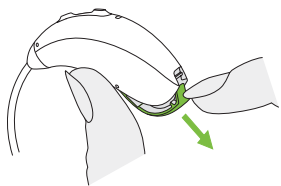

**off**

## Changing the battery

1

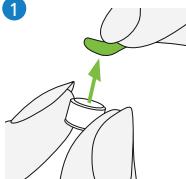

Remove the sticker from the new battery and wait two minutes.

2

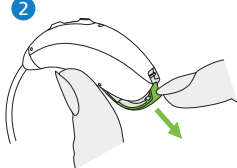

Open the battery door.

3

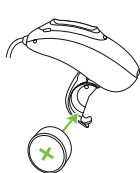

Place battery in the battery door with the "+" symbol facing upwards.

## Inserting the hearing aid

1

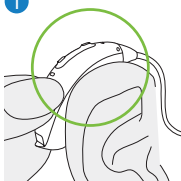

Place the hearing aid behind your ear.

2

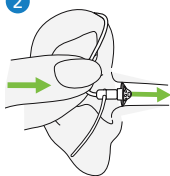

Insert the earpiece into your ear canal.

3

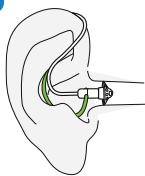

If there is a retention cord attached to the earpiece, tuck it into the bowl of your ear to secure your hearing aid.

## Changing the volume/program

The Multi-function button functions as a volume control and/or a program change depending on the hearing aid programming.

If activated a short press of the top button will increase the volume, a short press of the bottom button will decrease the volume.

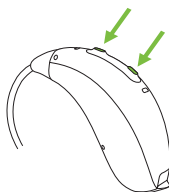

## Programme selection Autosense

1: \_\_\_\_\_ 2: \_\_\_\_\_

Your hearing aids are Bluetooth enabled. To pair your hearing aids to a compatible device, switch your hearing aids off and on. They will then go into a pairing mode for 3 minutes. Open the Bluetooth settings on your device and search for new equipment. This will usually display as R-Phonak NHS Hearing aid. Click on this and your device is paired.