

# Fitting Guide

## Nathos Nova M Earmould

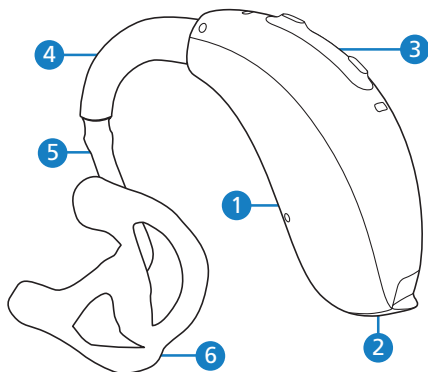

### Nathos™ Nova M Earmould

- 1 Right or left indicator\* on back of hearing aid
- 2 Battery compartment with ON/OFF switch
- 3 Multi-function button
- 4 Hook
- 5 Tube
- 6 Classic ear mould

\*Right = red | Left = blue

### Turning on the hearing system

Switch on/off the hearing system by opening/closing the battery compartment (below).

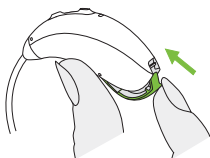

**on**

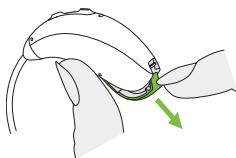

**off**



## Changing the battery

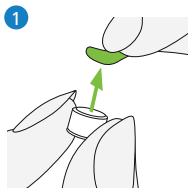

Remove the sticker from the new battery and wait two minutes.

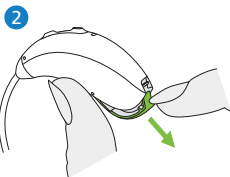

Open the battery door.

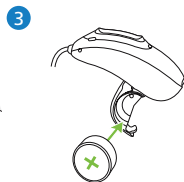

Place battery in the battery door with the "+" symbol facing upwards.

## Inserting the hearing aid

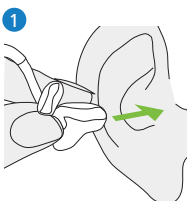

Take the earmould up to your ear and place the ear canal part into your ear canal.

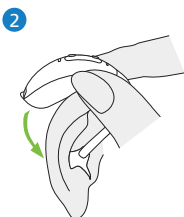

Place the hearing aid behind your ear.

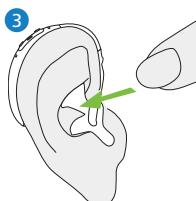

Make sure the upper part of the earmould is fully inserted into the upper part of the bowl of your ear.

## Changing the volume/program

The Multi-function button functions as a volume control and/or a program change depending on the hearing aid programming.

If activated a short press of the top button will increase the volume, a short press of the bottom button will decrease the volume.

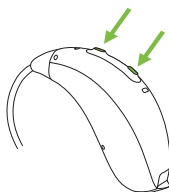

## Programme selection Autosense

1: \_\_\_\_\_ 2: \_\_\_\_\_

Your hearing aids are Bluetooth enabled. To pair your hearing aids to a compatible device, switch your hearing aids off and on. They will then go into a pairing mode for 3 minutes. Open the Bluetooth settings on your device and search for new equipment. This will usually display as R-Phonak NHS Hearing aid. Click on this and your device is paired.